

**BYLAW NO: 26/011**

**A BYLAW OF THE REGIONAL MUNICIPALITY OF WOOD BUFFALO TO AMEND THE MUNICIPAL DEVELOPMENT PLAN BYLAW NO. 24/015, ANZAC AREA STRUCTURE PLAN BYLAW NO. 12/018 AND LAND USE BYLAW NO. 26/001**

**WHEREAS** Section 632(1) of the *Municipal Government Act*, RSA 2000, c. M-26 requires Council to enact a Municipal Development Plan;

**WHEREAS** Section 633 (1) of the *Municipal Government Act*, RSA 2000, c. M-26 authorizes Council to enact a bylaw adopting an Area Structure Plan;

**WHEREAS** Section 640(1) of the *Municipal Government Act*, RSA 2000, c. M-26 requires Council to enact a Land Use Bylaw;

**AND WHEREAS** Section 191(1) of the *Municipal Government Act*, RSA 2000, c. M-26 authorizes Council to amend or repeal any Bylaw;

**NOW THEREFORE**, the Council of the Regional Municipality of Wood Buffalo, duly assembled and following a public hearing, enacts as follows:

1. Municipal Development Plan Bylaw No. 24/015 is hereby amended by:

Adding a portion of parcel in SW  $\frac{1}{4}$  21-86-7 W4M, described as PLS250014 to the Anzac boundary as depicted in Schedule "A".

2. The Anzac Area Structure Plan Bylaw No. 12/018 is hereby amended by:

Adding a portion of parcel in SW  $\frac{1}{4}$  21-86-7 W4M, described as PLS250014 to the Area Structure Plan boundary as depicted in Schedule "B".

Designating the portion added to the Area Structure Plan Boundary of parcel in SW  $\frac{1}{4}$  21-86-7 W4M, described as PLS250014 as Established Neighbourhood and depicted in Schedule "B".

3. Land Use Bylaw No. 26/001 is hereby amended by re-designating:

A portion of parcel SW  $\frac{1}{4}$  21-86-7 W4M, described as PLS250014 from RD – Rural District to HR1 – Hamlet Residential 1 District as depicted in Schedule "C".

4. This Bylaw comes into effect on the day it is passed.

Read a first time this \_\_\_\_\_ day of April, 2026.

Read a second time this \_\_\_\_\_ day of May, 2026.

Read a third time and final time this \_\_\_\_\_ day of May, 2026.

Signed and Passed this \_\_\_\_\_ date of \_\_\_\_\_ 2026

\_\_\_\_\_  
Mayor

\_\_\_\_\_  
Chief Legislative Officer

Schedule A

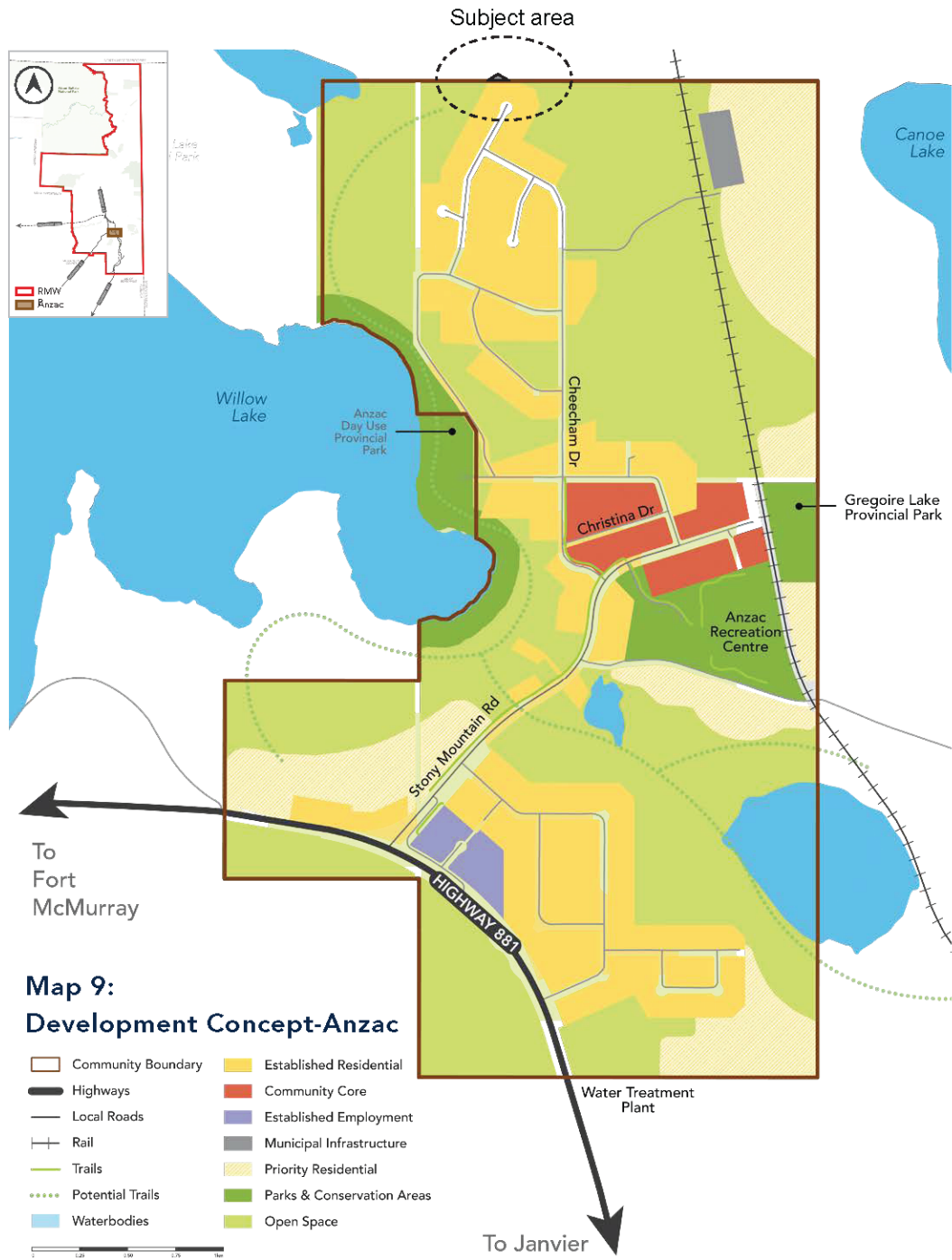

**Map 9:  
Development Concept-Anzac**

- Community Boundary
- Highways
- Local Roads
- Rail
- Trails
- Potential Trails
- Waterbodies
- Established Residential
- Community Core
- Established Employment
- Municipal Infrastructure
- Priority Residential
- Parks & Conservation Areas
- Open Space

**SUBJECT AREA**

**MDP Amendment to add part of SW ¼ 21-86-7 W4M (Provincial Disposition no. PLS250014) to the Anzac boundary**

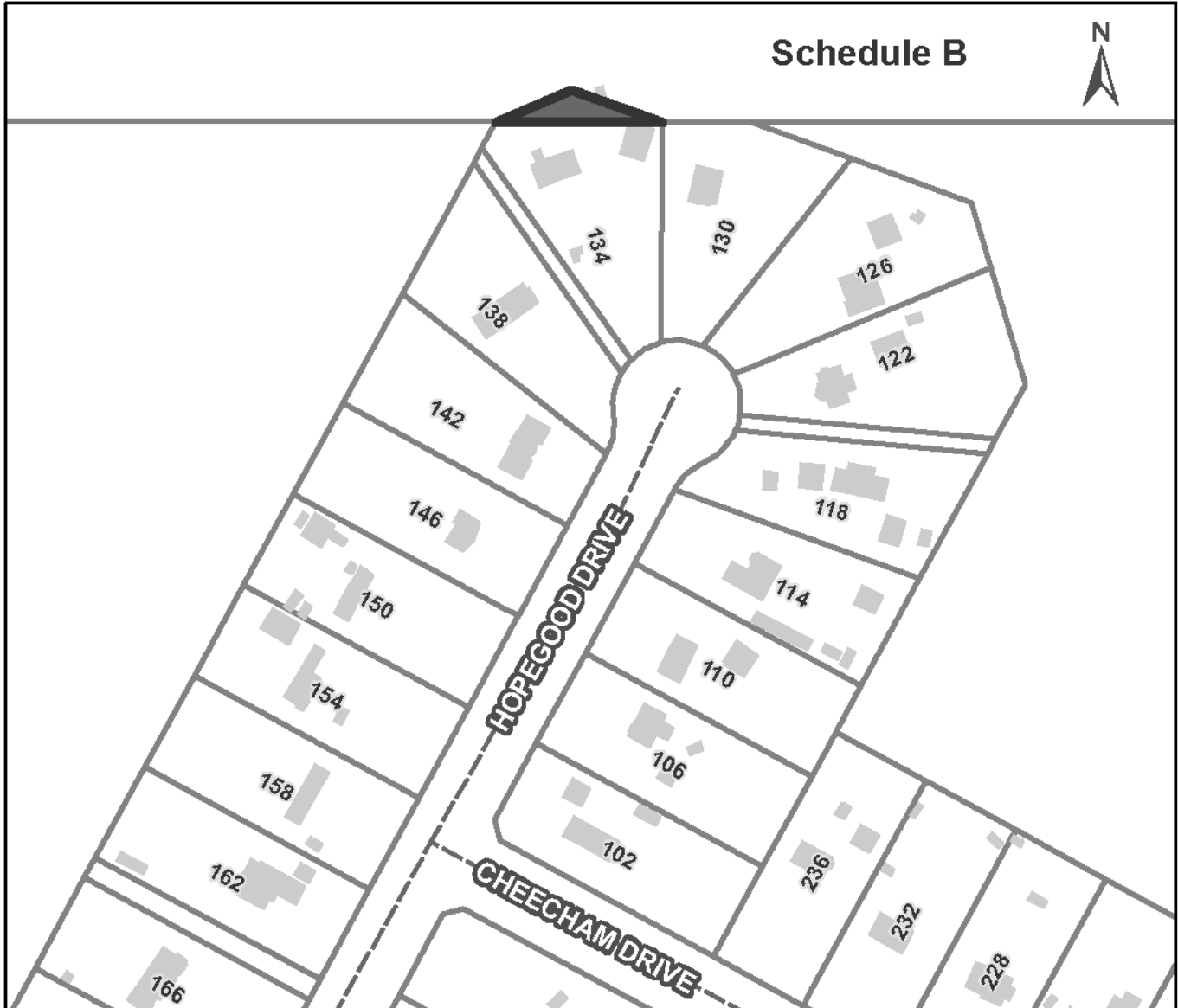

**SUBJECT AREA**

**ASP Amendment to add part of SW ¼ 21-86-7 W4M (Provincial Disposition no. PLS250014) to the Anzac ASP boundary and designate the added area as Established Neighbourhood**

25050507\_Media\_Map.mxd

Schedule C

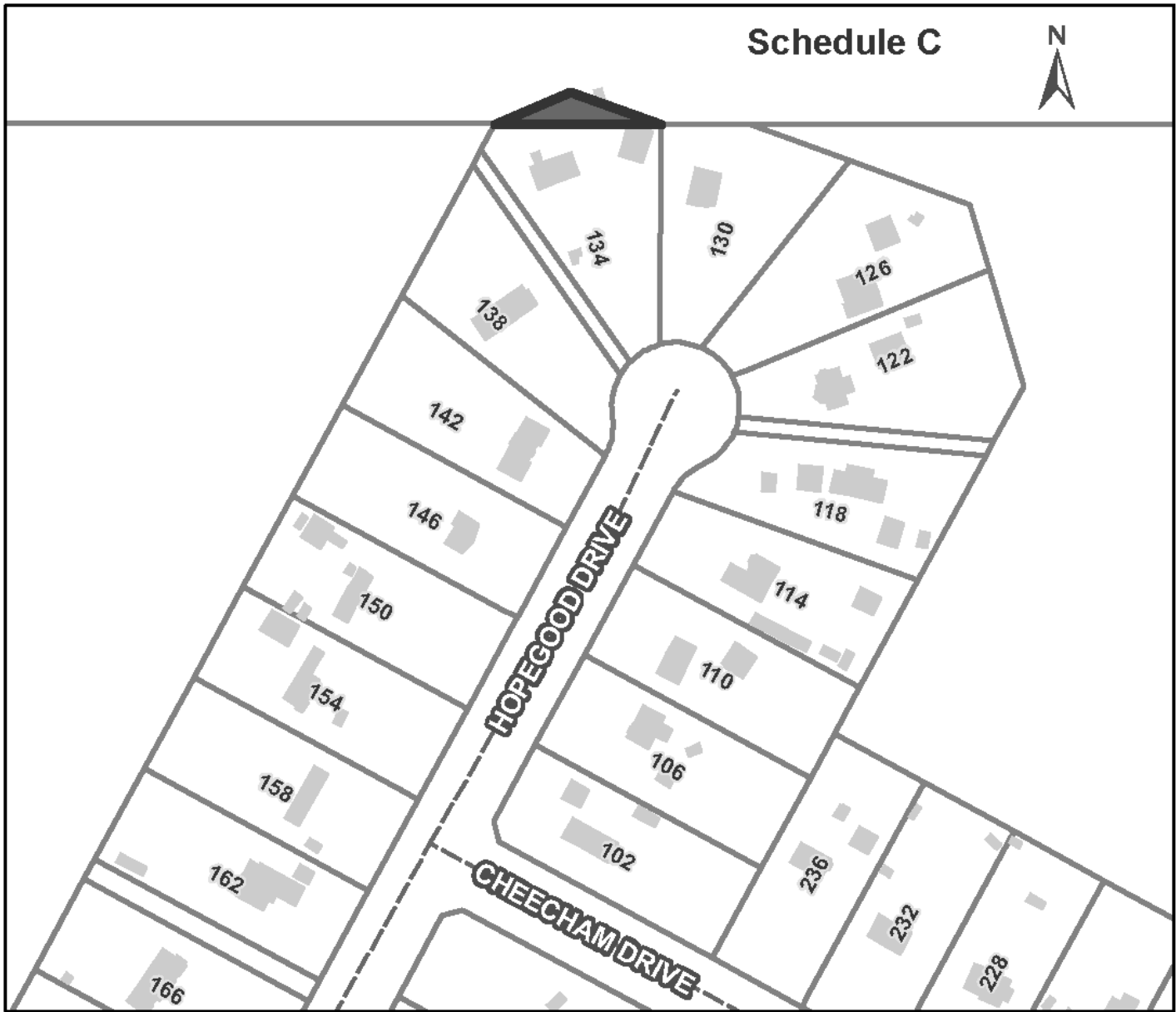

**SUBJECT AREA**

**LUB Amendment to redesignate part of SW ¼ 21-86-7 W4M (Provincial Disposition no. PLS250014) from RD – Rural District to HR1 – Hamlet Residential 1 District.**

25050507\_Media\_Map.mxd